

Foot Mounted Std. tefc motor AC Working

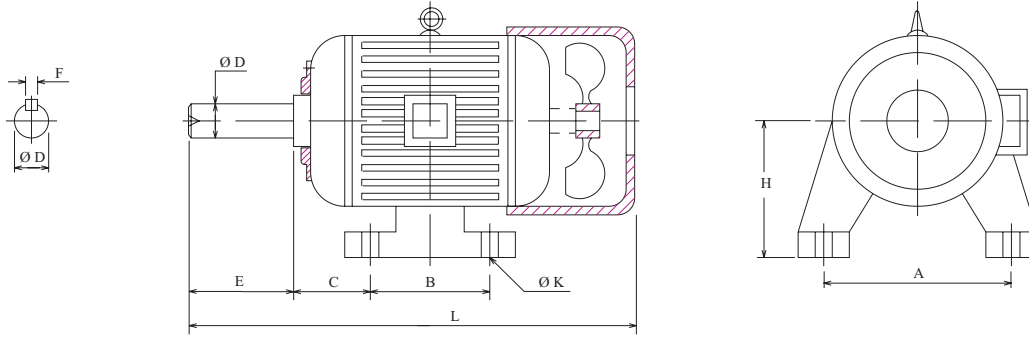

Frame Size	A	B	C	D	E	F	K	H	L
63	100	80	40	11	23	4	7	63	220
71	112	90	45	14	30	5	7	71	245
80	125	100	50	19	40	6	10	80	285
90S	140	100	56	24	50	8	10	90	315
90L	140	125	56	24	50	8	10	90	340
100L	160	140	63	28	60	8	12	100	380
112M	190	140	70	28	60	8	12	112	395
132S	216	140	89	38	80	10	12	132	455
132M	216	178	89	38	80	10	12	132	495
160M	254	210	108	42	110	12	15	160	600
160L	254	254	108	42	110	12	15	160	645

Note-1) Foot mounted motors as per IS:325 & IS:1231; with cooling fan.
 2) All Dimensions are in mm.

Drg. No.- B-3/ TEFC / STD. / 2007 / 1010.